

### Shuttle's new flagship of mini PCs in cube format

The Shuttle XPC P2 4800P complete mini PC system with Intel's X48 Express chipset sets a new milestone in terms of performance and makes dreams of even most power-hungry enthusiasts come true. Shuttle's new king of XPCs even takes Intel's most powerful processor with 1600MHz FSB, high-end PCI-Express graphics cards and DDR3 memory. Two 1 Terabyte hard disks do not mean a problem either. It also boasts an extensive range of features such as wifi, a fingerprint reader, USB speed link technology and bluetooth. Dual Gigabit-LAN, dual heatpipe cooling engine, a 450W 80+ certified PSU and two eSATA ports on the rear leave almost nothing to be desired. All this in cube format is only available from Shuttle.

### Shuttle XPC P2 4800P



Photos for illustration only.

Feature Highlight	
Category	<ul style="list-style-type: none"> <li>Performance</li> </ul>
Shuttle XPC	<ul style="list-style-type: none"> <li>Fully configured system based on Shuttle XPC Barebone SX48P2 Deluxe</li> </ul>
OS	<ul style="list-style-type: none"> <li>Microsoft Windows Vista (various versions)</li> </ul>
Deluxe-Features	<ul style="list-style-type: none"> <li>Fingerprint sensor</li> <li>USB Speed-Link</li> <li>Bluetooth 2.0</li> <li>WLAN 802.11 b/g</li> </ul>
Processor	<ul style="list-style-type: none"> <li>Intel Core 2 Duo/Quad/Extreme Socket 775, up to 1600 MHz FSB</li> </ul>
Memory	<ul style="list-style-type: none"> <li>Up to 4 modules DDR3-1066/1333/1600</li> </ul>
Graphics	<ul style="list-style-type: none"> <li>ATI/NVIDIA PCI-Express x16 graphics card</li> </ul>
Audio	<ul style="list-style-type: none"> <li>8-ch Audio with SPDIF out</li> <li>Supports Dolby Digital Live! and DTS Connect</li> </ul>
LAN	<ul style="list-style-type: none"> <li>Dual Gigabit Ethernet LAN (2x 1000 Mbit/s)</li> <li>Wireless LAN (802.11b/g)</li> </ul>
Drives	<ul style="list-style-type: none"> <li>16x DVD Writer, Dual Layer</li> <li>Serial ATA hard disk(s), up to 2x 1000GB</li> <li>Optional card reader</li> </ul>
Warranty	<ul style="list-style-type: none"> <li>24 months Pick-up and Return Service</li> </ul>
PSU	<ul style="list-style-type: none"> <li>SilentX 450W Power Supply, 80 PLUS</li> </ul>
Further configuration options	<ul style="list-style-type: none"> <li>It is possible to modify certain components of this basic configuration. Please refer to the "Shuttle Systems Configurator" on Shuttle's website <a href="http://sys.eu.shuttle.com">sys.eu.shuttle.com</a></li> </ul>



## Shuttle XPC P2 4800P – Special Product Features

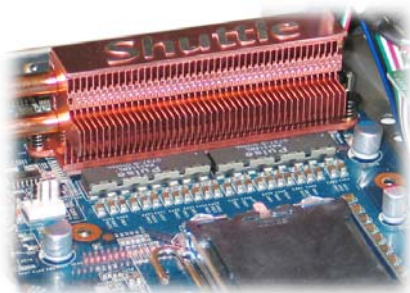

### Shuttle XPC Prima Series offering extreme performance

Shuttle has introduced the XPC Prima series, with its revolutionary high performance models, for professional and performance demanding applications whether they be at work, everyday or for high-tech gaming.

### Supports 1600 MHz FSB and 45nm processor technology

This Shuttle product can be configured with the Intel® Core™2 Duo and Intel® Core™2 Quad processors with up to 1600 MHz front side bus and even the new 45nm Core™2 Multi-core processors. Multi core brings multi power!

### 8-phase digital power design

Today's high end mainboards often have a 4-phase power design. The Shuttle XPC P2 4800P is based on a special 8 phase digital voltage regulator power design which has the advantage of quick transient response. It acts faster than 4-phase power designs to stabilize output current and voltage. This is especially critical when the CPU requires immediate current support when under heavy workload. Furthermore it operates at lower temperatures to increase component lifespan.

### OASIS Cooling Technology

The newly designed OASIS cooling technology deliver a unique system of heat-sinks covering the MOSFET modules, the north bridge as well as the south bridge that effectively dissipates heat without the use of fans. Featuring an all-new Heat pipe design, Shuttle OASIS allows users to enjoy longer component lifetime through lower temperatures, added system stability and silent operation.

### Supports up to four DDR3 memory modules

As a most functional and high-performance gaming platform, this XPC can be configured with up to four DDR3-1066/1333/1600 memory modules. DDR3 SDRAM provides a much higher frequency potential than DDR2. The X48 Express chipset was officially designed to work with 1600MHz FSB and DDR3-1600 RAM speeds to deliver ground-breaking performance for enthusiasts to speed up their systems even more.

### Supports two PCI Express x16 graphics cards

The Intel X48 chipset takes a major step beyond the P35 with its 32 PCI Express 2.0 lanes. The Shuttle XPC P2 4800P supports two slots PCI Express x16 Version 2.0 delivers up to 16GB/s bandwidth per port, double that of PCIe 1.0, ensuring plenty of bandwidth for future graphics cards. Two graphics cards can be used to enable 4-monitor operating.

### Finest cinematic surround sound experience

What would a home theater be without booming, immersive 7.1 channel surround sound? Experience state-of-the-art sound quality provided by Dolby® Digital Live and DTS® Connect functionality.

**450W** **80 PLUS**



### 80 PLUS® Certified Power Supplies

The 80 PLUS® performance specification requires power supplies in computers and servers to be 80% or greater energy-efficient. The SX48P2 Deluxe is in fact the first Shuttle XPC Barebone which has a powerful 450W power supply built in as standard.

### Fingerprint reader

With an added a layer of security protection thru the integrated biometric fingerprint reader, you can keep your digital identity and data more secure and no longer worry about having to memorize for memorizing multiple passwords.

### Innovative Speed-Link technology

File sharing among two PCs has never been easier with the innovative Speed-Link technology, simply connects both systems thru a USB cable without having the hassle of driver installation or worry about insufficient space of a DVD disc.

### WLAN and Bluetooth

The built-in Bluetooth 2.0 Dongle connects the Shuttle XPC with surrounding Bluetooth-capable peripherals. The integrated 802.11 b+g WLAN antenna make the Shuttle XPC ready for a wireless connectivity to Internet or to other home PCs.

### Dual Gigabit LAN with Teaming Support

This XPC features even two high-speed Gigabit LAN ports. The teaming function allows you to group both available network adapters together to function as a single adapter - a method of creating a virtual LAN. The benefit of this approach is that it enables load balancing and failover.

### Take multiple Terabytes of hard disk space

Currently, the Shuttle Systems Configurator offers a maximum configuration with two One-Terabyte-harddisks - which is plenty for the case capacity of just 15 litres.

### 2x eSATA with External Power

The back panel provides two external Serial ATA ports and a power port. The included cables make it a snap to connect your external hard drive to your XPC. The Serial ATA interface is up to six times faster than USB 2.0/Firewire.



### User Friendly Dynamic OverClock feature\*)

The user can easily overclock the system through the bios from 3%,5%,7% to10%.



### New Era of All-Solid Capacitor Shuttle Mainboards

By using all-solid capacitors Shuttle mainboards provide industry leading stability, reliability and longevity for PC gaming and entertainment systems. The average lifespan for a solid capacitor is more than six times greater than the more common and less expensive electrolytic capacitors.

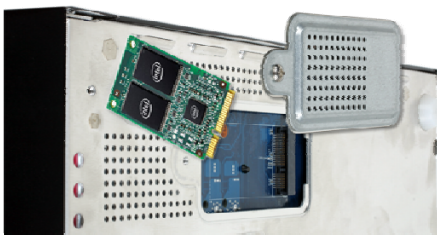

### Mini PCIe slot supports Intel Turbo Memory module

There is one Mini-PCIe x1 slot at the bottom of the chassis which supports Intel® Turbo Memory (codename: Robson). Intel® Turbo Memory lets your system actually learn your habits to provide better system response. That's because it stores frequently used information near the processor, where it's more quickly available.



### Supports Windows Vista Premium

Breathtaking Windows Aero™ 3D visual interface and a host of groundbreaking new features, Windows® Vista™ Premium promises to deliver a streamlined computing experience designed to fundamentally change how users view, find and organize their digital information.

#### \*) Overclocking Warning:

Please note there is a certain risk involved with overclocking, including adjusting the setting in the BIOS or using third-party overclocking tools. Overclocking may affect your system stability or even cause damage of the components and devices of your system. It is done at your own risk and expense. Shuttle cannot be held responsible for possible damage caused by overclocking.

## Shuttle XPC P2 4800P Specifications

<i>Range of application</i>	Performance
<i>Basis</i>	System based on: the Shuttle XPC Barebone SX48P2 Deluxe
<i>Deluxe-Features</i>	Fingerprint recognition technology - brings convenient security to your PC Speed-Link - easily connect 2 PCs via USB and share data Wireless LAN 802.11b/g for wireless networking Bluetooth 2.0 transceiver is useful for connecting phones, printers, etc.
<i>Operating system</i>	Microsoft Windows Vista (various versions available) 9 languages available: German, English, French, Dutch, Italian, Spanish, Swedish, Finnish, Danish
<i>Chassis</i>	Black P2-type aluminum chassis, stealthed drive doors dimensions: 32.5 x 22 x 21 cm (LWH)
<i>Processor</i>	Socket 775 with Intel Core 2 Duo / Quad / Extreme processor with 800, 1066, 1333 or 1600 MHz front side bus with 65nm- or 45nm-technology up to Intel Core 2 Quad Extreme QX9770 with 3.2GHz / 1600MHz FSB
<i>Silent X Cooling</i>	New Shuttle I.C.E. heat-pipe module (Integrated Cooling Engine) SilentX Cooling and Noise Reduction Technology advanced Heatpipe technology, linear fan control. 3 independent cooling areas. OASIS Cooling Technology: additional fanless heat-pipe design covering the MOSFET modules (VRM), north- and southbridge
<i>Chipset Capacitors</i>	Chipset: Intel X48 Express (MCH) + ICH9R (I/O Controller Hub) Solid Capacitors for excellent heat resistance for enhanced system durability
<i>Hard disks</i>	One or two Serial ATA hard disks, supports 3 Gbit/s
<i>Optical drive</i>	16x DVD Writer, supports Dual Format and Dual Layer
<i>Memory</i>	With up to four DDR3-1066/1333/1600 memory modules (240 pins) Max. 2GB capacity per DIMM module, supports Dual Channel
<i>Graphics</i>	PCI Express x16 graphics card from ATI or NVIDIA Optionally with two graphics cards (supports 4 monitors) Outputs: Sub-D (analog)*, DVI-I (digital/analog) and TV (S-Video/Composite) *) Sub-D connector may be provided by adapter

<i>7.1 Audio</i>	7.1 channel High Definition Audio, Realtek ALC888DD codec Supports Dolby® Digital Live! and DTS™ Connect (Digital Theater Systems) analog: line-out (8-ch), line-in, microphone, CD-in, AUX digital: optical and coaxial S/PDIF-out
<i>Dual LAN</i>	2x RJ45 connectors supports Teaming mode *) 2x Marvell 88E8056 Ethernet network controller With PCI Express x1 interface IEEE 802.3u 1000Base-T compliant Supports 10 / 100 / 1.000 MBit/s operation Supports Wake-on-LAN
<i>Card Reader</i>	optionally with 3.5" multi-format card reader (USB 2.0)
<i>Empty slots</i>	1x PCI-Express x16 (if only one single-slot graphics card is chosen) 1x Mini-PCIe x1 slot at the bottom of the chassis supports Intel Turbo Memory (codename: Robson)
<i>Front-panel I/O</i>	Microphone, Headphone (Line-out), 2x USB 2.0 Fingerprint recognition, Fingerprint Sensor, Speedlink On/Off button Power button with LED, Reset button Hard disk LED, Bluetooth LED, WiFi (WLAN) LED
<i>Back-panel I/O</i>	6x USB 2.0 2x Gigabit LAN (RJ45) 2x External Serial ATA (eSATA) with power port and cable 8-ch Audio line-out (2x rear/front, bass/center, surround/back) Digital Audio S/PDIF output: optical and coaxial Audio Line-in Audio Microphone input Clear CMOS button Wireless LAN Antenna
<i>Power supply</i>	450 Watt ATX mini PSU, AC input voltage: 100~240V 80 PLUS® certified (80% or greater energy-efficient) Dimensions: 85(W) x 83(H) x 150(D) mm Connectors: 20-pin ATX, 4-pin ATX12V Active PFC circuit (Power Factor Correction) With AC power switch
<i>Warranty</i>	24 Months Pick-Up-And-Return Service
<i>Further configuration options</i>	It is possible to modify certain components of this configuration. Please refer to the "Shuttle Systems Configurator" on Shuttle's website <a href="http://sys.eu.shuttle.com">http://sys.eu.shuttle.com</a>

**\*) Teaming Mode**

The teaming function allows you to group both available network adapters together to function as a single adapter - a method of creating a virtual LAN. The benefit of this approach is that it enables load balancing and failover.

Shuttle XPC P2 4800P Connectors

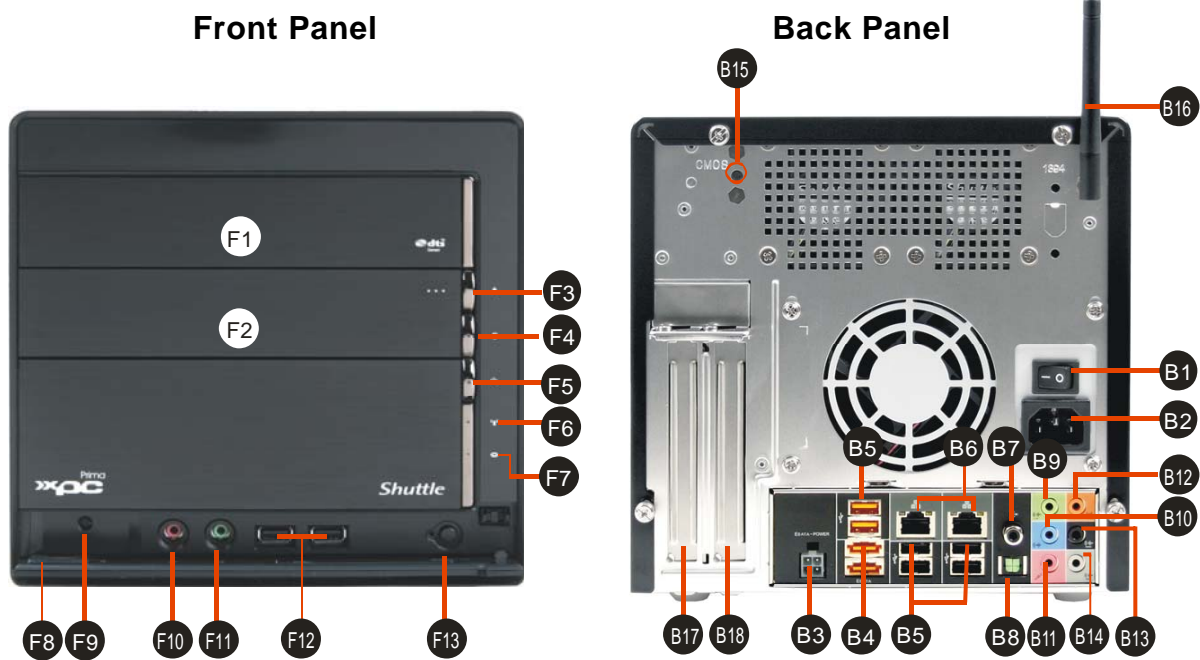

**Front Panel**

- F1 5.25" bay
- F2 3.5" bay
- F3 Eject button
- F4 HDD LED
- F5 Power Switch & LED
- F6 WLAN LED
- F7 Bluetooth LED
- F8 Fingerprint sensor
- F9 Reset Button
- F10 Microphone input
- F11 Headphone output
- F12 USB 2.0 Ports
- F13 Speed-link on/off

**Back Panel**

- B1 AC Power Switch
- B2 AC Power Socket
- B3 External SATA power
- B4 External SATA ports
- B5 USB 2.0 ports
- B6 Dual Gigabit LAN ports
- B7 S/PDIF out (coaxial)
- B8 S/PDIF out (optical)
- B9 Line out (front)
- B10 Line in
- B11 Microphone in
- B12 Line out (center/bass)
- B13 Line out (back)
- B14 Line out (side)
- B15 Clear CMOS button
- B16 Wireless LAN antenna
- B17 PCI Express x16 slot
- B18 PCI Express x16 slot