

Highly versatile entry-level PC

Being the first model of the new product line which is based on the J1 case design, the XPC J1 4110B is highly versatile in use and good value for money. The J1 chassis also supports the Mini-ITX standard - this makes future upgrades very easy. The Intel technologies housed inside such as Core 2 / Pentium processors and the G41 Express chipset are joined by an array of connectors. As an option, you can order this system with a discrete graphics card and a second hard disk which provides up to 4TB of storage capacity.

Shuttle XPC J1 4110B



©2010 by Shuttle Computer Handels GmbH (Germany). All information subject to change without notice. Pictures for illustration purposes only.

Feature Highlight

Category	<ul style="list-style-type: none"> Basic (Business)
Shuttle XPC	<ul style="list-style-type: none"> Based on Shuttle XPC Barebone SG41J1 Plus Chipset: Intel G41 + ICH7
OS	<ul style="list-style-type: none"> Windows 7 or Windows XP Downgrade (several versions and languages available)
Processor	<ul style="list-style-type: none"> Intel Pentium Dual-Core, Core 2 Duo or Core 2 Quad (Socket 775)
Memory	<ul style="list-style-type: none"> DDR3-1333, Dual Channel up to 4 GB
Integrated graphics	<ul style="list-style-type: none"> Intel GMA X4500, up to 1759MB UMA DirectX 10, Shader 4.0, DVI Video out
Optional graphics card	<ul style="list-style-type: none"> PCIe x16 Grafikkarte ATI or NVIDIA (The integrated graphics function cannot be used at the same time)
Audio	<ul style="list-style-type: none"> 5.1 channel audio
LAN	<ul style="list-style-type: none"> Gigabit Ethernet LAN
Drives	<ul style="list-style-type: none"> Optical drive: DVD combo or DVD writer Serial ATA II hard disk up to 2000GB Optional with second hard disk drive Optional with serial and parallel port
Warranty	<ul style="list-style-type: none"> 24 months Pick-up and Return Service
Further configuration options	<ul style="list-style-type: none"> It is possible to modify certain components of this configuration. Please refer to the "Shuttle Systems Configurator" on Shuttle's website sys.eu.shuttle.com

Picture for illustration purposes only.

Shuttle XPC J1 4110B Specifications (configurable)

<i>Range of application</i>	Basic (Business)
<i>Basis</i>	Shuttle XPC Barebone SG41J1 Plus
<i>Operating system</i>	Microsoft Windows 7 (various versions available, including Windows XP downgrade) 9 languages available: German, English, French, Dutch, Italian, Spanish, Swedish, Finnish, Danish
<i>Chassis</i>	J1-type chassis made of steel, color: black Storage bays: 1x 13.5cm (5.25") external, 2x 8.9cm (3.5") internal Dimensions: 32.5 x 21.5 x 19 cm (LWH) = 13.3 liters Kensington Security Slot at the back panel (also called a K-Slot or Kensington lock) as a part of an anti-theft system
<i>Chipset & BIOS</i>	Chipset: Intel G41 Express + ICH7 AMI BIOS, SPI interface, 8MB Flash ROM Supports PnP, ACPI 3.0 Supports external USB flash memory card boot up
<i>Processor</i>	Socket 775 Intel Core 2 Quad, Core 2 Duo, Pentium Dual Core, Celeron Dual-Core, Celeron 4xx With 800, 1066 or 1333 MHz front side bus (FSB) Intel boxed cooling fan, rpm-controlled
<i>Memory</i>	2 x 240 pin DIMM memory slots With 2 or 4 GB DDR3-1333 memory
<i>Optical drive</i>	Multi-format DVD writer or DVD Combo drive optional
<i>Hard disk</i>	Serial ATA hard disk up to 2000 GB Second hard disk as an option.
<i>Integrated Graphics</i>	Intel Graphics Media Accelerator X4500 (GMA X4500) Supports Microsoft DirectX 10, Shader Model 4.0 und OpenGL 2.0 Supports Intel Clear Video Technology with ProcAmp color control Maximum DVI resolution: 2048x1536 Max. shared video memory size (UMA): 1759MB*)
<i>Optional PCIe x16 graphics card</i>	Discrete ATI or NVIDIA graphics card optional If a discrete graphics card is used, the onboard graphics will be deactivated.

<i>6ch Audio</i>	<p>Audio Codec: IDT 92HD89C, 5.1 channel</p> <p>Three analog audio connectors (3.5mm) at the Back-Panel:</p> <ol style="list-style-type: none"> 1) Front Line out (head phone) 2) Rear Surround line-out 3) Center line-out <p>Front panel: microphone input and head phone output</p>
<i>Giga LAN</i>	<p>Marvell 88E8057 Ethernet network controller (Gigabit)</p> <p>Supports 100 / 1.000 MBit/s operation (100Base-TX/1000Base-T)</p> <p>Supports Wake-on-LAN (WOL)</p>
<i>Front-panel I/O</i>	<p>Microphone (3,5 mm)</p> <p>Headphone /Line-out (3,5 mm)</p> <p>2x USB 2.0 (Hi-Speed)</p> <p>Power button</p> <p>Power on LED (blue)</p> <p>Hard disk read/write LED (orange)</p>
<i>Back-panel I/O</i>	<p>DVI-D output (24 pin, digital)</p> <p>Optional VGA Sub-D (15 pin, analog) - with graphics card only</p> <p>4x USB 2.0 (Hi-Speed)</p> <p>GigaBit LAN (RJ45)</p> <p>PS/2 keyboard (6-pol. Mini-DIN)</p> <p>PS/2 mouse (6-pol. Mini-DIN)</p> <p>Audio Line in, Line out, Microphone</p> <p>Clear CMOS button</p> <p>Serial and parallel port (optional)</p>
<i>Power supply</i>	<p>250 Watt mini power supply unit</p> <p>Input voltage range: 100~240V</p> <p>Connectors: 20-pin ATX, 4-pin ATX12V</p> <p>Active PFC (Power Factor Correction)</p>
<i>Warranty</i>	<p>24 Months Pick-Up-And-Return Service</p>
<i>Further configuration options</i>	<p>It is possible to modify certain components of this basic configuration. Please refer to the "Shuttle Systems Configurator" on Shuttle's website http://sys.eu.shuttle.com</p>

***) Shared Memory Size**

The shared memory size is dynamically controlled by VGA driver, and the Max. shared memory size will be available only when 4GB or more memory is installed under 64-bit OS.

Shuttle XPC J1 4110B Black – Connectors

Front View

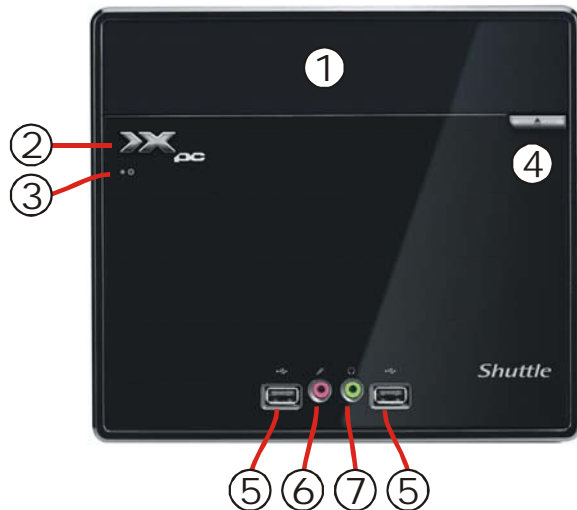

- (1) Optional DVD drive
- (2) Power button
- (3) Power LED
- (4) DVD Eject button
- (5) 2x USB ports
- (6) Microphone input
- (7) Headphone output

Rear View

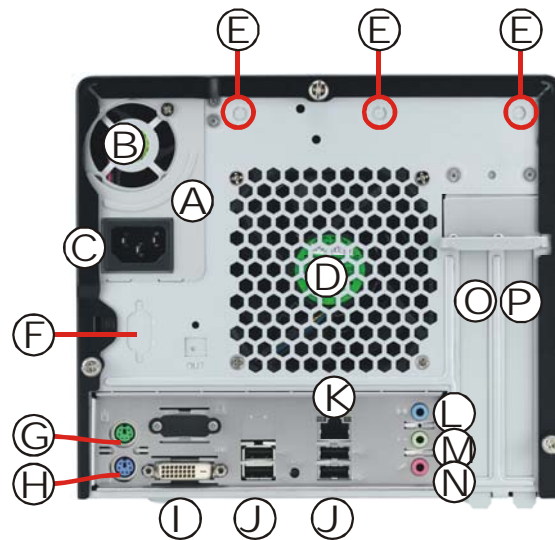

- (A) Power supply consist of
- (B) PSU cooling fan and
- (C) AC power connector
- (D) Chassis cooling fan
- (E) Wireless LAN perforation
- (F) Serial port perforation
- (G) PS/2 mouse port
- (H) PS/2 keyboard port

- (I) DVI-D video port (digital)
- (J) 4x USB ports
- (K) RJ45 LAN port
- (L) Audio Line-in port
- (M) Audio Line-out port
- (N) Microphone-in port
- (O) Graphics card slot (optional)
- (P) PCI slot (optional COM/LPT)

Back panel connectors

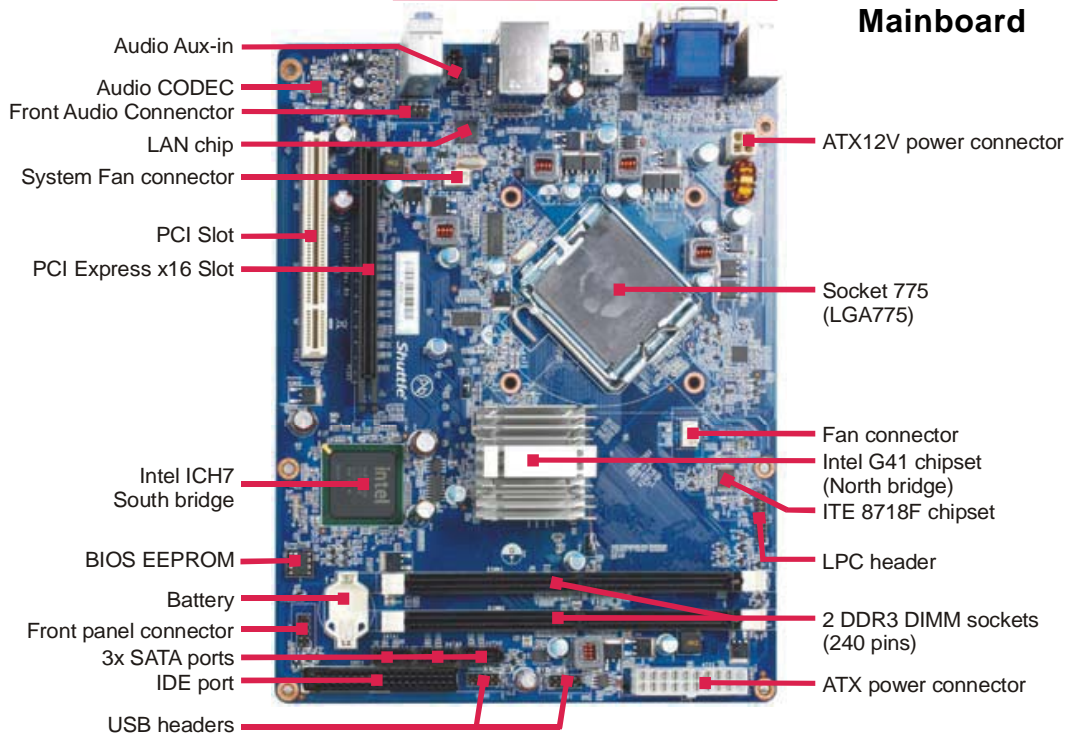

Mainboard

©2010 by Shuttle Computer Handels GmbH (Germany). All information subject to change without notice. Pictures for illustration purposes only.