

Highly versatile entry-level PC

Being the first fully configured Mini PC System of the brand-new product line which is based on the J1 case design, the XPC J1 4110BA is highly versatile in use and good value for money. The Intel technologies housed inside such as the Intel Pentium E6500 processor and the G41 Express chipset are joined by an array of connectors.

Shuttle XPC J1 4110BA

Feature Highlight	
Category	<ul style="list-style-type: none"> Basic (Business)
Shuttle XPC	<ul style="list-style-type: none"> Based on Shuttle XPC Barebone SG41J1 Plus Chipset: Intel G41 + ICH7
OS	<ul style="list-style-type: none"> Windows XP Professional as a Downgrade from Windows 7 Professional (several languages available)
Processor	<ul style="list-style-type: none"> Intel Pentium Dual-Core E6500 (2x 2.933 GHz)
Memory	<ul style="list-style-type: none"> 2GB DDR3-1333
Integrated graphics	<ul style="list-style-type: none"> Intel GMA X4500, up to 1759MB UMA DirectX 10, Shader 4.0, DVI Video out
Audio	<ul style="list-style-type: none"> 5.1 channel audio
LAN	<ul style="list-style-type: none"> Gigabit Ethernet LAN
Drives	<ul style="list-style-type: none"> Optical drive: DVD Reader 320GB Serial ATA II hard disk
Other	<ul style="list-style-type: none"> Legacy ports: serial and parallel
Warranty	<ul style="list-style-type: none"> 24 months Pick-up and Return Service



Product ID: J1 4110BA
Order No: PCT-J1411BA1



The configuration of the Shuttle XPC J1 4110BA is only one of several configurations available of the Shuttle XPC J1 4110B series. Please refer to the **Shuttle Systems Configurator** (sys.eu.shuttle.com) to see the full range of other possible built-to-order (BTO) systems.

Picture for illustration purposes only.

Pictures are for illustration only.

Shuttle XPC J1 4110BA Specifications

<i>Range of application</i>	Basic (Business)
<i>Basis</i>	Shuttle XPC Barebone SG41J1 Plus
<i>Operating system</i>	Microsoft Windows XP Professional as a Downgrade from Windows 7 Professional 9 languages available: German, English, French, Dutch, Italian, Spanish, Swedish, Finnish, Danish
<i>Chassis</i>	J1-type chassis made of steel, color: black Storage bays: 1x 13.5cm (5.25") external, 2x 8.9cm (3.5") internal Dimensions: 32.5 x 21.5 x 19 cm (LWH) = 13.3 liters Kensington Security Slot at the back panel (also called a K-Slot or Kensington lock) as a part of an anti-theft system
<i>Chipset & BIOS</i>	Chipset: Intel G41 Express + ICH7 AMI BIOS, SPI interface, 8MB Flash ROM Supports PnP, ACPI 3.0 Supports external USB flash memory card boot up
<i>Processor</i>	Intel® Pentium® Processor E6500 (Socket 775) CPU clock rate: 2x 2.933 GHz with 1066MHz Front Side Bus (FSB), L2-Cache: 2MB Power consumption (TDP): max. 65W Dual-Core "Wolfdale" in 45nm production process Intel boxed cooling fan, rpm-controlled
<i>Memory</i>	2 GB DDR3-1333 memory
<i>Optical drive</i>	Multi-format DVD Reader
<i>Hard disk</i>	320GB Serial ATA hard disk
<i>Integrated Graphics</i>	Intel Graphics Media Accelerator X4500 (GMA X4500) Supports Microsoft DirectX 10, Shader Model 4.0 und OpenGL 2.0 Supports Intel Clear Video Technology with ProcAmp color control Maximum DVI resolution: 2048x1536 Max. shared video memory size (UMA): 1759MB*)
<i>6ch Audio</i>	Audio Codec: IDT 92HD89C, 5.1 channel Three analog audio connectors (3.5mm) at the Back-Panel: 1) Front Line out (head phone) 2) Rear Surround line-out 3) Center line-out Front panel: microphone input and head phone output

©2010 by Shuttle Computer Handels GmbH (Germany). All information subject to change without notice. Pictures for illustration purposes only.

<i>Giga LAN</i>	<p>Marvell 88E8057 Ethernet network controller (Gigabit) Supports 100 / 1.000 MBit/s operation (100Base-TX/1000Base-T) Supports Wake-on-LAN (WOL)</p>
<i>Front-panel I/O</i>	<p>Microphone (3,5 mm) Headphone /Line-out (3,5 mm) 2x USB 2.0 (Hi-Speed) Power button Power on LED (blue) Hard disk read/write LED (orange)</p>
<i>Back-panel I/O</i>	<p>DVI-D output (24 pin, digital) 4x USB 2.0 (Hi-Speed) GigaBit LAN (RJ45) PS/2 keyboard (6-pol. Mini-DIN) PS/2 mouse (6-pol. Mini-DIN) Audio Line in, Line out, Microphone Clear CMOS button Serial and parallel port</p>
<i>Power supply</i>	<p>250 Watt mini power supply unit Input voltage range: 100~240V Connectors: 20-pin ATX, 4-pin ATX1 2V Active PFC (Power Factor Correction)</p>
<i>Warranty</i>	<p>24 Months Pick-Up-And-Return Service</p>

***) Shared Memory Size**

The shared memory size is dynamically controlled by VGA driver, and the Max. shared memory size will be available only when 4GB or more memory is installed under 64-bit OS.

©2010 by Shuttle Computer Handels GmbH (Germany). All information subject to change without notice. Pictures for illustration purposes only.

Shuttle XPC J1 4110BA – Connectors

Front View

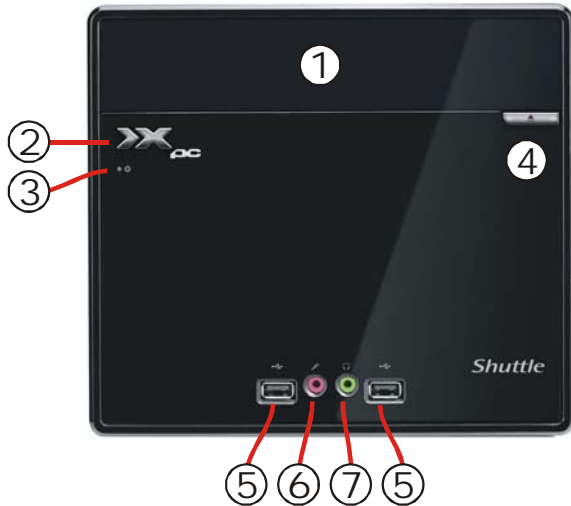

- (1) DVD Reader drive
- (2) Power button
- (3) Power LED
- (4) DVD Eject button
- (5) 2x USB ports
- (6) Microphone input
- (7) Headphone output

Rear View

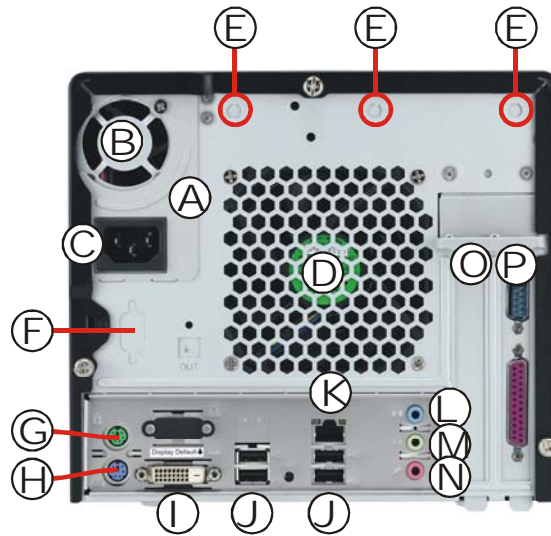

- (A) Power supply consist of
- (B) PSU cooling fan and
- (C) AC power connector
- (D) Chassis cooling fan
- (E) Wireless LAN perforation
- (F) Serial port perforation
- (G) PS/2 mouse port
- (H) PS/2 keyboard port
- (I) DVI-D video port (digital)
- (J) 4x USB ports
- (K) RJ45 LAN port
- (L) Audio Line-in port
- (M) Audio Line-out port
- (N) Microphone-in port
- (O) PCI-Express X16 slot
- (P) PCI slot with COM/LPT bracket

Back panel connectors

Mainboard

