

VESA Dual Stand POV21 Black

ROBUST VESA DUAL STAND FOR AIO-PCs AND PANEL-PCs

The Shuttle POV21 is a robust Dual VESA stand in black for one or two screens up to 21.5". The sturdy construction made of high-quality aluminium alloy carries loads of up to 20 kg without bending. It features universal pitch angle adjustment and an internal cable slot which makes for a clean, tidy appearance on the desk. Installation is simple: first the VESA brackets are screwed to the display and then snapped and secured onto the stand. This high-quality stand is ideal for POS systems (consisting of AIO PC and customer display) or for Panel-PCs in industrial environments.



Use with one VESA bracket



...or with two VESA brackets



For illustration purposes only

COMPATIBILITY

- Compatible with Shuttle All-in-One PCs Series: X50V4...X50V9, P20U, P22U, P25N, P51U, P52U, P90U, P92U
- Compatible with Shuttle Panel-PCs Series: P21WL/ALxx, P15WL/ALxx

MATERIAL & DESIGN

- Colour: black
- Unique stylish design with rounded edges
- Stand made of aluminum alloy, some parts made of steel and plastic
- Easy installation with two detachable VESA brackets

GENERAL FEATURES

- Suitable for single and dual screen use
- Screen recommendations: 9.7" – 21.5"
- Vesa hole distance: 75x75 and 100*100 mm
- Vesa screws supplied in two different lengths
- Adjustable tilt angle (depends on the displays):
(1) 270° up, 30° down - (2) 120° up, 10° down

OPTIMIZED CABLE MANAGEMENT

- Hidden cable duct and screwless magnetic back cover

LOAD CAPACITY AND STABILITY

- Strong load bearing capacity: max. 20 kg
- Anti slip rubber feet
- Stand can be screwed to surfaces (two M3 threads)

DIMENSIONS & WEIGHT

- Base plate: ca. 213 mm (W) x 218 mm (D)
- Stand height: 232 mm (without VESA bracket)
- Package: 270 x 270 x 270 mm
- Weight: 2570 g net, 3150 g gross

PACKAGE CONTENTS

- Stand with magnetic back cover
- VESA brackets (x2), Dummy cover (x1)
- VESA screws: M4 x 8 mm (x8) and M4 x 12 mm (x8)
- Countersunk head screws M4 x 8 mm (x4) to fix the brackets
- Material to cover openings on the PC
- Installation Guide



Approved for these Shuttle products:

Shuttle XPC All-in-One PCs (Plastic, IP54)			Shuttle Panel-PCs (Aluminum, IP65)		
11.6" P20U P22U P25N	15.6" P51U P52U	15.6" (X50-Series) X50V7 X50V8 X50V9	19.5" P90U P92U	15.6" P15WL01 P15AL01	21.5" P21WL01, M21WL01 P21AL01, M21AL01

SCOPE OF DELIVERY



PRODUCT FEATURES



For one or two devices

The flexible design of POV21 ensures secure stability, regardless of whether you install a single device or even two. This stand supports All-in-one-PCs and displays with mounting options according to VESA 75/100 standard (four M4 threads with 75x75mm or 100x100mm pitch).



Optimised Cable Management

POV21 features a hidden cable duct which is covered with a screwless magnetic back cover. This helps avoid clutter and makes for a clean, tidy appearance on the desk and provides better protection for the cables.



Screen recommendations

POV21 is recommended for All-in-One-PCs and Displays with a diagonal screen size of 9.7" to a maximum of 21.5".



Flexible and easy to adjust

The tilt angle can be easily adjusted to the desired position. High-quality hinges ensure that the position is reliably maintained during touch operation.



Strong load bearing capacity

The POV21 stand made of robust aluminium alloy can support a weight of up to 20 kg. Tests have shown that no deformation, bending or twisting has occurred.



Safe positioning

Four feet on the underside ensure high slip resistance on the surface. In addition, the stand can be firmly screwed in place with two suitable M3 screws (screws not included).

Installation Guide

1. If necessary: remove the original stand of the PC/monitor to be installed. In some cases, openings in the housing will be visible here, which should be covered for safety reasons: for the Shuttle AIO X50Vx/P90U/P92U series, use the supplied protective sheet or for P20U/P22U/P25U/P51U/P52U the supplied adhesive strips (see image).

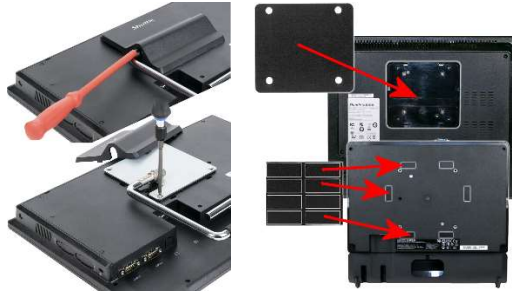

2. Screw one VESA mount with four screws (M4 x 8 mm) to your PC/monitor that is to be attached to the stand.

Note: for the Shuttle AIO X50Vx/P90U/P92U series, use the longer M4 x 12 mm screws).



3. Place the PC/monitor (with the VESA holder mounted) on the stand and secure it with two countersunk screws.



4. Remove the magnetic cover from the stand and route the required cables. Then click the cover back onto the stand (without screws).



5. Adjust the tilt angle of the screen.



6. Optionally, a second PC/monitor can be installed. To do this, remove the blind cover and use the second VESA holder with four screws. Proceed as for the first installation (step 2-5).



7. Optionally, you can screw the stand to the base. Select suitable M3 screws for this (not supplied).



Photo Gallery



Dimensions and Technical Drawing

